

# SIC2 Console and Nose Cone Installation

<b>Date</b>	7 Jan 2022
-------------	------------

## Overview

Standard operating procedure for installing an SIC2 console and associated nose cone onto an SC3.18 or earlier model, essentially upgrading the bike to an SC3.20.

All SC3.20s come standard with the SIC2 console and nose cone. However, they are compatible with the SIC1 console as well. Contact Stages Customer Support (1-800-717-8076) for assistance if using an SIC1 console with an SC3.20.

## Common Service Indicators

- Customer preference
- SC3 upgrade to 3.20

## Bike Model Applications

- All SC3 models

## Estimated Time Required



15 mins.

## Tools Required

- 2.5mm hex key
- 3mm hex key

**Parts required and procedure begin on next page**

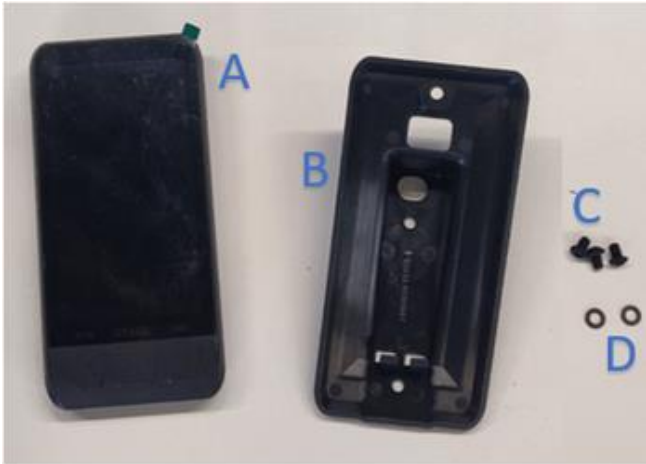
Parts Required

<ul style="list-style-type: none"><li>971-0455 - Console SIC2</li></ul> 		<ul style="list-style-type: none"><li>000-8174 - Kit, Nose Cap, SC3, w/hdwr</li></ul> 	
A: Console	B: Console base		
C: Button head screw (x3)	D: Flat washer (x2)	E: Nose cone	F: Socket head screw (x2)

Procedure

1. Use a 2.5mm hex key to slightly loosen the lower screw on the left and right water bottle holders (no need to remove the screw).



2. Rotate the water bottle holders upward, then use a 3mm hex key to remove the two (2) screws (one on each side) from the original nose cone (Fig. 1). Use both hands to gently pry apart the nose cone as you pull it off the frame (Fig. 2), then disconnect the wires that are now visible (Fig. 3).

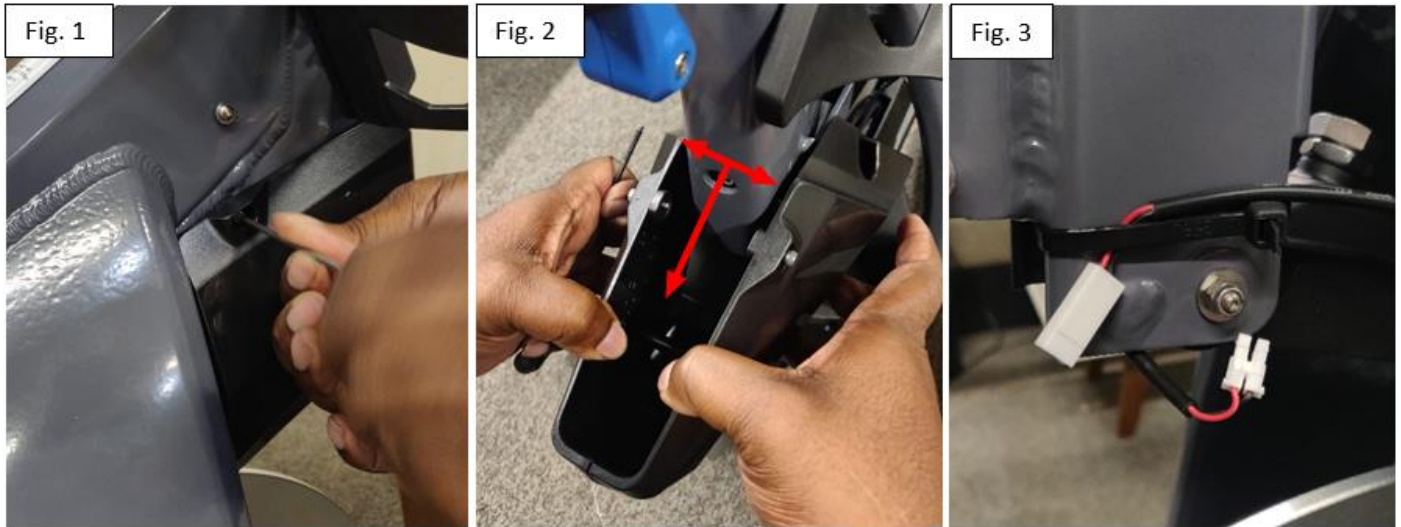

3. Use a 3mm hex key to remove the side panel containing the PCB and wires from the new nose cone (item **E** in parts needed).



4. Gently pull apart the new nose cone and set it loosely onto the frame of the bike so that the disconnected wires are accessible through the gap (Fig 1). Connect the wires from the PCB within the side panel to the wires from the bike (Fig. 2).

**There is only one way to connect these wires: [PCB jumper cable male to bike frame female], [PCB female to bike frame male]. (There are 3 connections visible in Fig. 2 because one of the wires from the PCB comes with a short jumper cable pre-attached.)**

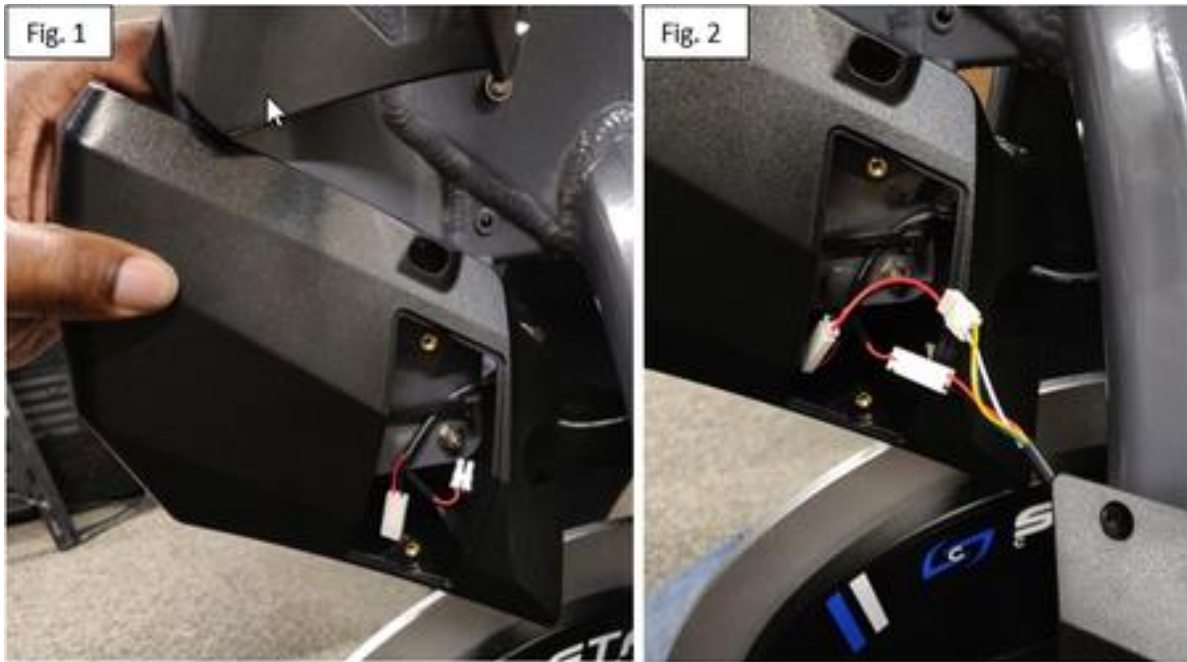

5. Push the connected wires into the nose cone (Fig. 1) and reinstall the side panel using a 3mm hex key (Fig. 2).

**Make sure the wires stay connected and are not pinched within the nose cone.**





6. Align the screw holes in the nose cone with the screw holes in the frame (one on each side) and secure the nose cone to the frame using the two (2) socket head screws (item **F**) and a 3mm hex key (Fig. 1). Then rotate the water bottle holders on each side back down into place and gently tighten the lower screws using a 2.5mm hex key.

**Be sure that the washer attached to each screw is in front of the plastic of the water bottle holder (Fig. 3). Do not overtighten or the hardware will eat through the plastic.**

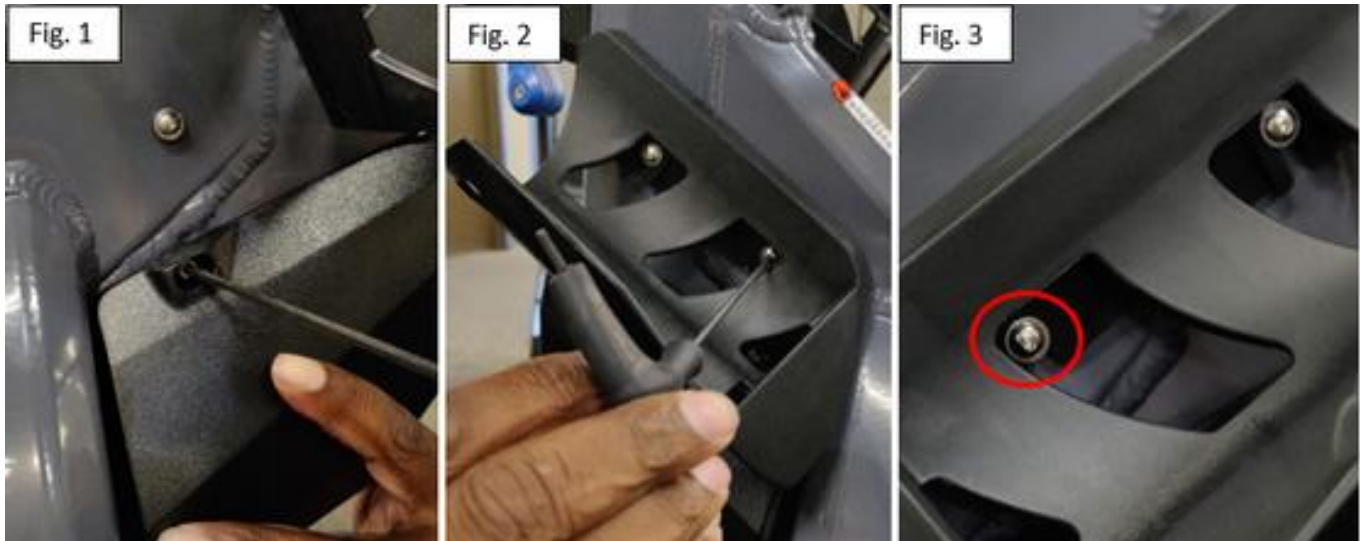

**If the bike you are working with has a pre-installed SIC1 console, remove it now. Contact Stages Customer Support (1-800-717-8076) for assistance. If the bike does NOT have a pre-installed console, continue to step 7 directly below.**

**If you plan to install a media shelf, see [here](#) for video instructions prior to proceeding.**

7. Thread the power wire at the top of the handlebar stem through the larger round gap in the console base (item **B**) (Fig. 1) and set the console base on top of the handlebar stem (Fig. 2).

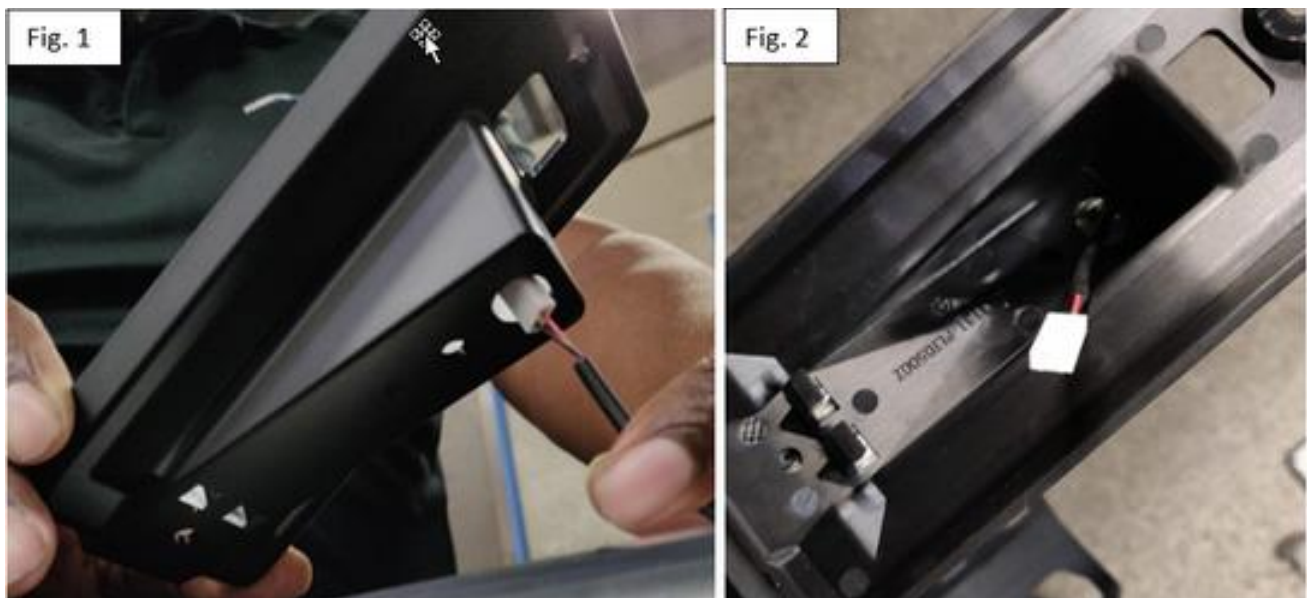

8. Tilt the console base to the side so you can see the rectangular nuts within the channel on top of the handlebar stem and align the nuts with the screw holes in the console base (Fig. 1). Use a 3mm hex key to begin to thread two (2) button head screws with two (2) washers (items **C** and **D**) into the nuts. Do not fully tighten at this time.

**Prior to fully tightening the screws, slide the console base toward the rear of the bike so that the edge of the console base meets but does not overlap the black handlebar stem endcap (Fig. 3). Fully tighten the screws once the base is aligned.**



9. Connect the console wire to the power wire ensuring to match up the red and black terminals (Fig. 1). Align the wires into the center channel of the console base so they will not be pinched, then attach the console to the base by snapping it into place (Fig. 2).

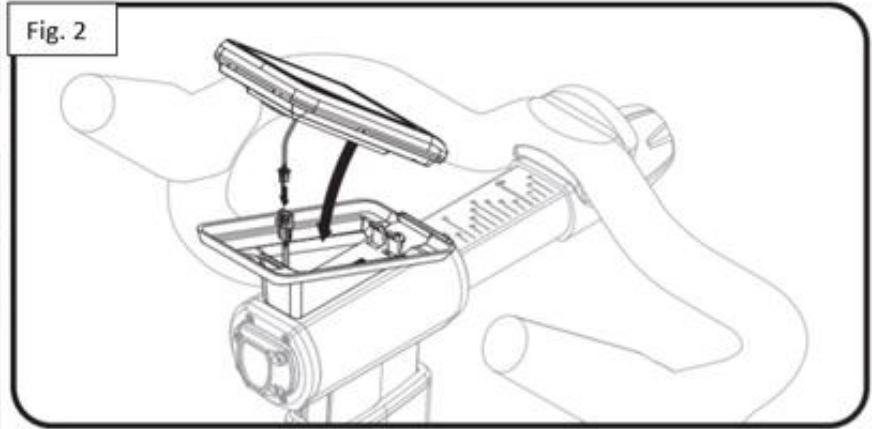

10. Use the final button head screw (item C) and a 3mm hex key to complete the console installation. The last screw hole is above the USB port on the underside of the console.

**This screw is installed at a slight angle - perpendicular to the slope of the console. Do not attempt to insert the screw pointing straight up or you may cross thread the screw.**



11. Peel off the screen protector, then follow [this link](#) for instructions showing how to pair the Stages power meter to the SIC2 console. For additional reference, see the [SIC2 Console User Guide](#).



**If your console is flickering upon installation, the battery is low and needs to be charged. To charge the battery, simply ride the bike. Pedaling at greater than 90rpm will charge the battery the quickest.**

**If your console is flickering *while you are riding*, there is likely a pinched wire or loose connection somewhere. Double check the wires and connections made in steps 4 and 9 of this procedure. If the flickering issue persists, contact Stages Customer Support at 1-800-717-8076 or [support@stagesindoorcycling.com](mailto:support@stagesindoorcycling.com) for assistance.**